



200 x 195 x 125 mm



2 kg



Steel / HDG



BS EN 13374, class A

Description

The VT Foot is suitable for connection to horizontal surfaces, such as a concrete slab. Its four supporting points on the underside of the foot allow for a very fast and straight forward installation.

A distinct tether point marked with orange labeling indicates where a user should connect a carabiner or similar.

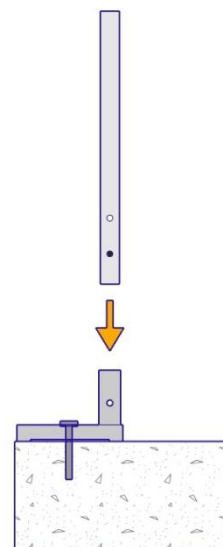
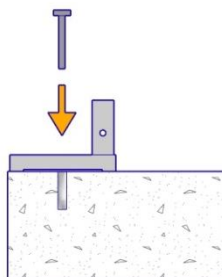
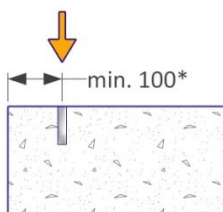
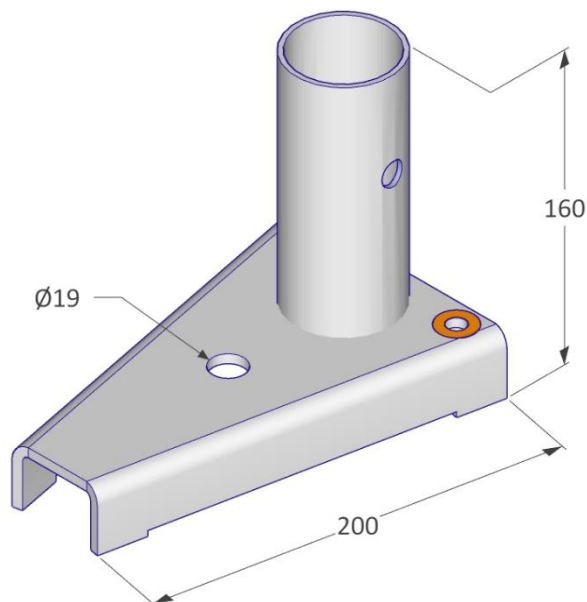

mm

*may differ, please see charts of the respective screw manufacturer



250 pcs / Eurobox



1240 x 835 x 970 mm



488 kg

Means of Fixation

Tensile load of the screws min. 10 kN
→ Hilti HUS3-H10 L-130mm or the like / better, assembly torque limit min. 60 Nm

General Safety

Health and Safety Regulations should be followed at all times. For more information → viva-tec.co.uk/safety